

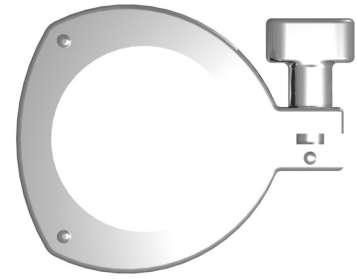

TriClamp Clamp | 13MHHS-Size-S

Part Number	Size
13MHHS-1.5-S	1" or 1-1/2"
13MHHS-2-S	2"
13MHHS-2.5-S	2-1/2"
13MHHS-3-S	3"
13MHHS-4-S	4"

S = 304 Stainless Steel



TriClamp Clamp | 13MHHS-0.75-S

Part Number	Size
13MHHS-0.75-S	1/2" or 3/4"

S = 304 Stainless Steel

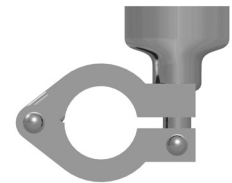

TriClamp Clamp | 13MHP-Size-S

Part Number	Size
13MHP-1.5-S	1" or 1-1/2"
13MHP-2-S	2"
13MHP-2.5-S	2-1/2"
13MHP-3-S	3"
13MHP-4-S	4"

S = 304 Stainless Steel

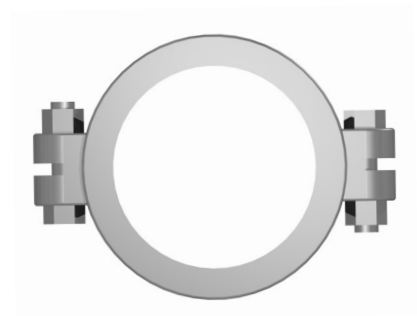

TriClamp Clamp | A13MHM-Size-S

Part Number	Size
A13MHM-1.5-S	1" or 1-1/2"
A13MHM-2-S	2"
A13MHM-2.5-S	2-1/2"
A13MHM-3-S	3"
A13MHM-4-S	4"

S = 304 Stainless Steel



TriClamp Solid End Cap | 16AMP-Size-AL6XN-Finish

"-7" Finish Part Number	Size	Length (A)
16AMP-0.75-AL6XN-7	1/2" or 3/4"	0.19
16AMP-1.5-AL6XN-7	1" or 1-1/2"	0.25
16AMP-2-AL6XN-7	2"	0.25
16AMP-2.5-AL6XN-7	2-1/2"	0.25
16AMP-3-AL6XN-7	3"	0.25
16AMP-4-AL6XN-7	4"	0.25

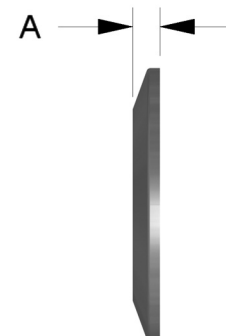



Gaskets, Standard TriClamp | 40MP-Material & 42MP-Material

Material	Nominal Size & Availability						
	1/2	3/4	1	1-1/2	2	3	4
40MP-U (Buna)			X	X	X	X	X
42MP-U (Buna)	X	X					
40MP-X (Silicone)			X	X	X	X	X
42MP-X (Silicone)	X	X					
40MP-E (EPDM)			X	X	X	X	X
42MP-E (EPDM)	X	X					
40MP-G (PTFE)			X	X	X	X	X
42MP-G (PTFE)	X	X					
40MP-SFY (Viton)			X	X	X	X	X
42MP-SFY (Viton)	X	X					

