

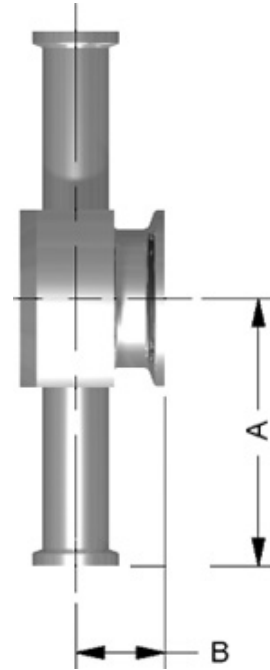

TriClamp Instrument Tee | B7IMPS-Size-AL6XN-Finish

"-7" Finish Part Number	Size (Run x Branch)	Length (A)	(B)
B7IMPS-0.5X1.5-AL6XN-7	1/2 x 1 1/2	3.000	0.875
B7IMPS-0.5X2-AL6XN-7	1/2 x 2	3.250	1.000
B7IMPS-0.75X1.5-AL6XN-7	3/4 x 1 1/2	3.000	1.000
B7IMPS-0.75X2-AL6XN-7	3/4 x 2	3.250	1.125
B7IMPS-1X1.5-AL6XN-7	1 x 1 1/2	3.000	1.125
B7IMPS-1X2-AL6XN-7	1 x 2	3.250	1.250
B7IMPS-1.5X2-AL6XN-7	1 1/2 x 2	3.250	1.500

Dimensions "A" and "B" meet requirements per ASME BPE table DT-29.



Weld Instrument Tee | B7IWWMS-Size-AL6XN-Finish

"-7" Finish Part Number	Size (Run x Branch)	Length (A)	(B)
B7IWWMS -0.5X1.5-AL6XN-7	1/2 x 1 1/2	2.500	0.875
B7IWWMS -0.5X2-AL6XN-7	1/2 x 2	2.750	1.000
B7IWWMS -0.75X1.5-AL6XN-7	3/4 x 1 1/2	2.500	1.000
B7IWWMS -0.75X2-AL6XN-7	3/4 x 2	2.750	1.125
B7IWWMS -1X1.5-AL6XN-7	1 x 1 1/2	2.500	1.125
B7IWWMS -1X2-AL6XN-7	1 x 2	2.750	1.250
B7IWWMS -1.5X2-AL6XN-7	1 1/2 x 2	2.750	1.500

Dimensions "A" and "B" meet requirements per ASME BPE table DT-28.

